

March 27, 2017

(This English translation was released on March 31, 2017)

Aplix IP Holdings Corporation

(Code: 3727 TSE Mothers)

## **Aplix Launches a One Stop Solution Featuring IoTIZR™ a New External IoT Device, Ideal for Making Water Purifiers IoT-Capable First Showing at the WQA Convention & Exposition**

Aplix IP Holdings Corporation (headquartered in Shinjuku-ku, Tokyo, Representative Director Kengo Nagahashi, hereinafter “Aplix”) and its subsidiary, Aplix Corporation of America, announce that they have developed an ideal solution featuring IoTIZR™ - a new external IoT device - to make water purifiers IoT-capable. IoTIZR is to be put on the market in the U.S. and Europe. They have also announced that an exhibition and demonstration of this IoT solution featuring IoTIZR will be given at the WQA Convention & Exposition. This event will be held in Florida, U.S.A., from Tuesday, March 28 to Friday, March 31.

The IoTIZR is a small device connected to various sensors. It receives data from them and sends it to smartphones or the cloud. In contrast to the ready-to-embed IoT modules such as JM1 that Aplix has mainly offered on the market, IoTIZR is a product that is used with existing sensors. At the WQA Convention & Exposition, Aplix will exhibit and demonstrate the IoT solution that uses a flow sensor to measure flow rate and IoTIZR to send it to the Aplix cloud through Wi-Fi.

This IoT solution includes the three items introduced below. The main feature of IoTIZR is the easy installation that lets users choose their desired flow sensors without having to modify their water purifiers. This makes them IoT-capable, and usage is sent to the cloud.

### **1. IoTIZR**

The main specifications and features are as follows:

#### **◆ Size and weight**

IoTIZR will be exhibited at the WQA Convention & Exposition with a case to contain it as shown on the right but cases can be freely designed and made as per requirements, such as the expected installation environment and the desired power specifications.

#### **◆ Communication**

Wi-Fi and Bluetooth Low Energy (BLE) are available for communication with the cloud and smartphones. Wi-Fi and BLE can both be enabled at the same time.

#### **◆ Power supply**

Dry cell batteries and power supply through USB are supported.

#### **◆ Supported sensors**

Various flow sensors are supported.

To connect sensors other than flow sensors, please contact Aplix.



Illustration of IoTIZR connected to water flow sensor

## ◆ Attachment

Users can connect and attach flow sensors to IoTIZR by themselves.

## ◆ Security

Communication between IoTIZR and the cloud or smartphones is encrypted. In addition, anti-spoofing measures are put in place to prevent unauthorized users from tampering with IoTIZR data.

## 2. Cloud services

Every data sent from IoTIZR will be securely managed and provided in an easy-to-use format for showing purifier filter usage, estimating battery exchange period, managing customers assigned to repairers, and analysis performed by marketers. The display content can be customized to meet different needs.

Data can be viewed using a web browser, so repairers can check data using a smartphone or tablet outside the office.

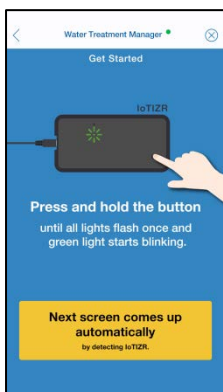
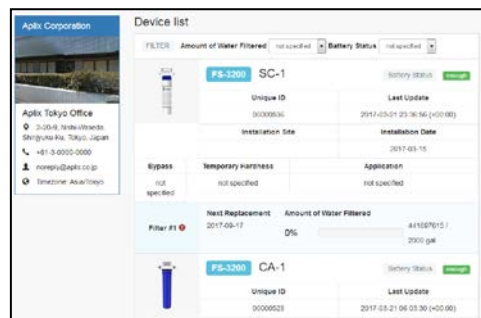

## 3. Smartphone app for configuration

This is an app for repairers to register and reconfigure IoTIZR. Both iPhone and Android versions will be available.

At the WQA Convention & Exposition, in addition to the above-mentioned IoT solution, the Beacon-Embedded Water Flow Sensor with Quick Connect Fittings will also be exhibited. This device has been chosen by Franke, the largest kitchen sink maker in the world (see the Aplix press release of January 20, 2016: *World's Foremost Kitchen Sink Manufacturer announces Internet of Things (IoT) Water Purifier System using Aplix IoT Solution – Water purifiers already installed and in use can easily be upgraded to accelerate the conversion to IoT –*).

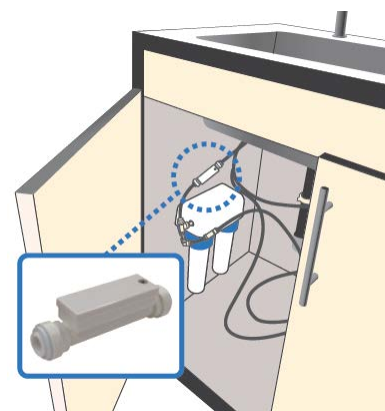

This product just needs to be attached to an existing water purifier as a joint, as shown on the right, to make it IoT-capable. It does not need to be embedded in the water purifier and no new components need to be developed. For details, see [Beacon-Embedded Water Flow Sensor with Quick Connect Fittings](#) on the Aplix web site.

Going forward, Aplix will continue to be particularly focused on the development of IoT solutions that are easy to install, convenient, and safe to use.

## About the WQA Convention & Exposition

This is an exposition held by the Water Quality Association for the water purifier industry. For details, see the official site [WQA Convention & Exposition](#).

## Aplix booth

Our booth number is “1146.” Click [here](#) to see the map.

## ■ About the Aplix IP Holdings Group

The mission of Aplix IP Holdings is to use the power of software to bring happiness to everyone in the world. Following the success of JBlend, which opened a new frontier for Java on mobile phones, we are currently developing the field of IoT (Internet of Things). By supplying IoT solutions from IoT modules (beacons), smartphone apps to cloud services, we aim to advance the transition of household appliances and other products to being IoT-equipped devices and in doing so, realize our concept of “enriching people’s lives with notifications from things.”

Aplix IP Holdings website (Investor Relations): <http://www.aplix-ip.com/en/>

Aplix website (Technology Business): <http://www.aplix.co.jp/en/>

## ■ Inquiries:

Aplix IP Holdings Public Relations: [http://www.aplix-ip.com/en/contact\\_en/](http://www.aplix-ip.com/en/contact_en/)

\* The names of companies and products included in this press release are trademarks or registered trademarks of their respective companies.

Disclaimer: This English translation is for reference purposes only. In the event of any discrepancy between the Japanese original and this English translation, the Japanese original shall prevail. We assume no responsibility for this translation or for direct, indirect or any other form of damage arising from the translation.